

AREA OF RESCISSION
SEE SHEET 2 OF 2
FOR DETAILS

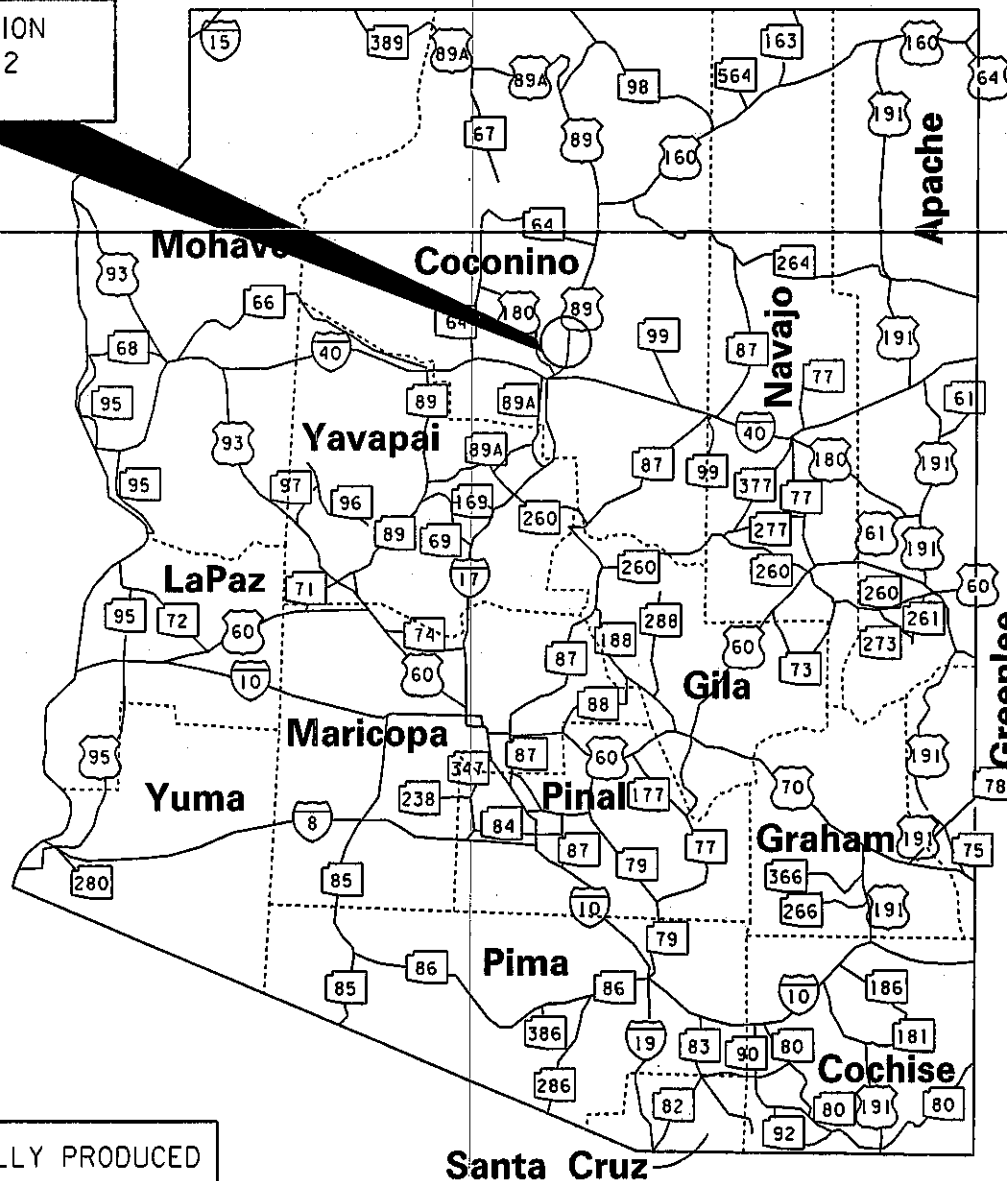

THIS PLAT WAS DIGITALLY PRODUCED
FROM ARIZONA DEPARTMENT OF
TRANSPORTATION
GENERAL HIGHWAY MAP

RIGHT OF WAY PLANS SECTION
REVISED MAY 17, 2000

APPENDIX "A"

089 CN 426 H6531 01R / U-089-C-700
FLAGSTAFF - CAMERON HWY
Forest Service Boundary. -
Lenox Park Rd.
Coconino County

DATE: SEPT. 23, 2005 SHEET: 1 OF 2



To Flagstaff
7 miles

To Cameron
38 miles

US 89

To Sunset Crater
Nat'l Monument

M.P. 428

M.P. 425.8

Lenox Park

Campbell Lane

T. 23 N. R. 8 E.
T. 22 N. R. 8 E.

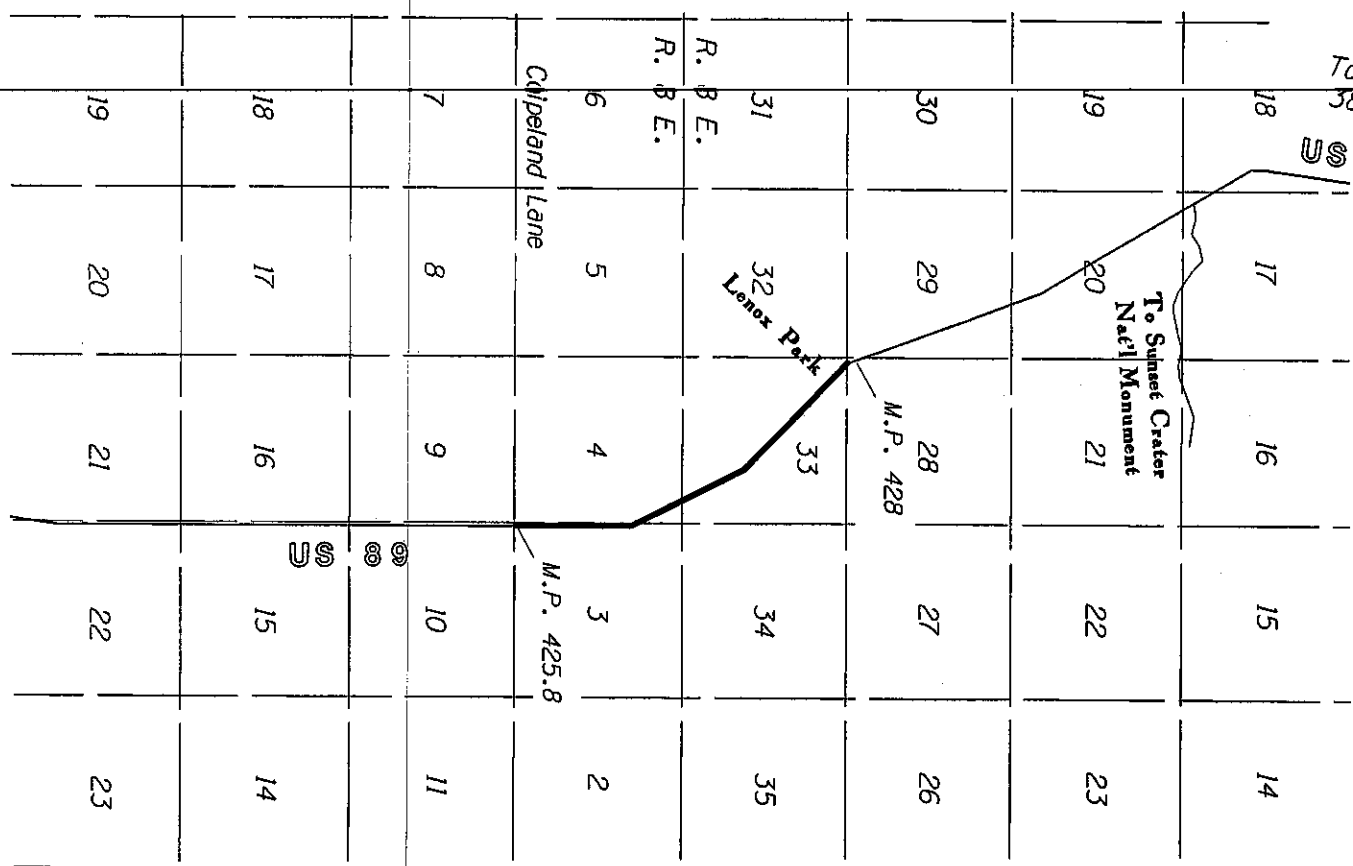

THIS PLAT WAS DIGITALLY PRODUCED
FROM ARIZONA DEPARTMENT OF
TRANSPORTATION
GENERAL HIGHWAY MAP

RIGHT OF WAY PLANS SECTION
REVISED JULY 17, 2000

AREA OF
RESCISSION



APPENDIX "A"

089 CN 426 H6531 OIR / U-089-C-700
FLAGSTAFF - CAMERON HWY
Forest Service Boundary. -
Lenox Park Rd.
Coconino County

DATE: SEPT. 23, 2005 SHEET: 2 OF 2