

AREA OF ESTABLISHMENT
SEE SHEET 2 OF 2
FOR DETAILS

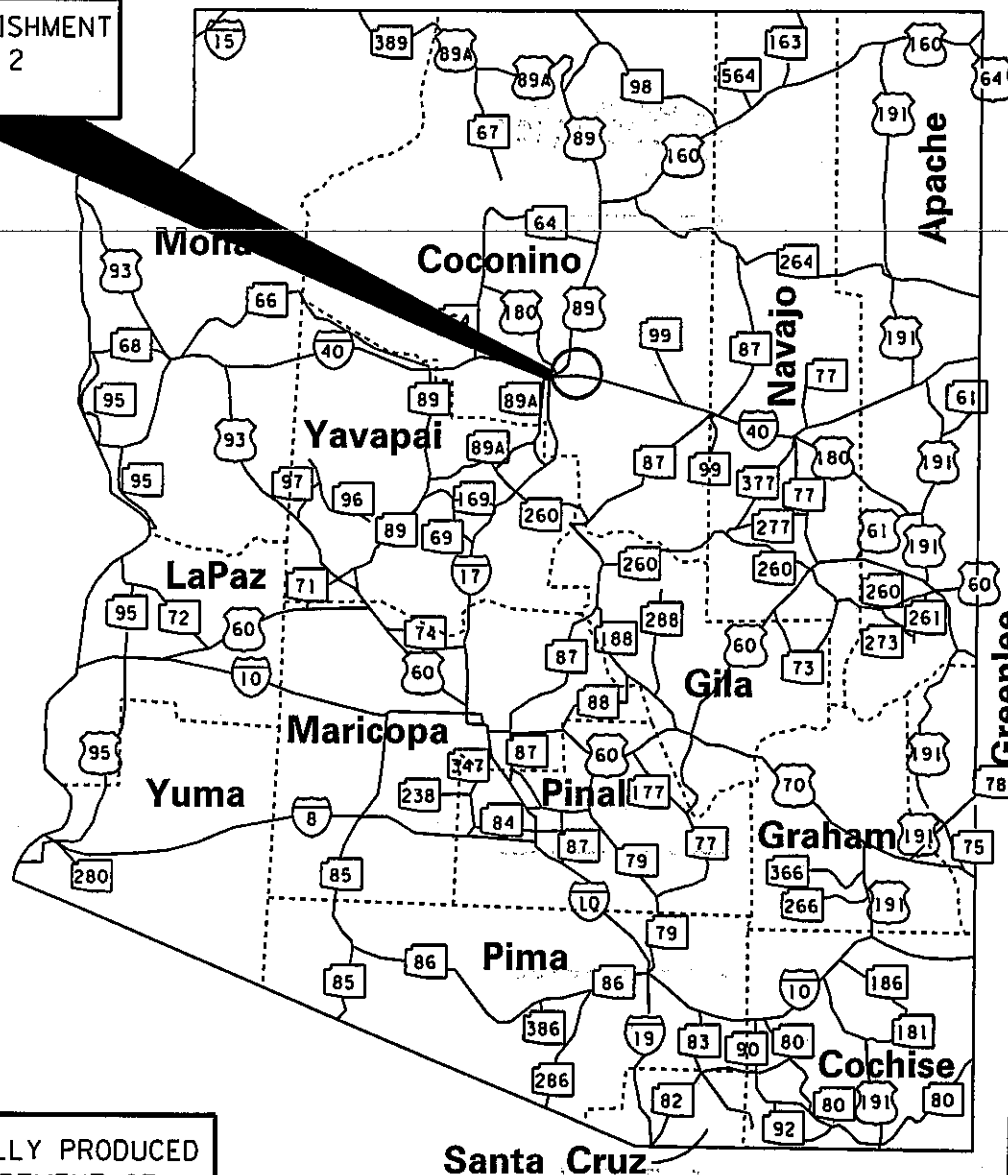

THIS PLAT WAS DIGITALLY PRODUCED
FROM ARIZONA DEPARTMENT OF
TRANSPORTATION
GENERAL HIGHWAY MAP

RIGHT OF WAY PLANS SECTION
REVISED MAY 17, 2000

APPENDIX "A"

089 CN 418 H5106 02R / U 089-C-801
FLAGSTAFF - CAMERON
East Flagstaff T. I.
Coconino County

DATE: MARCH 18, 2005 SHEET: 1 OF 2

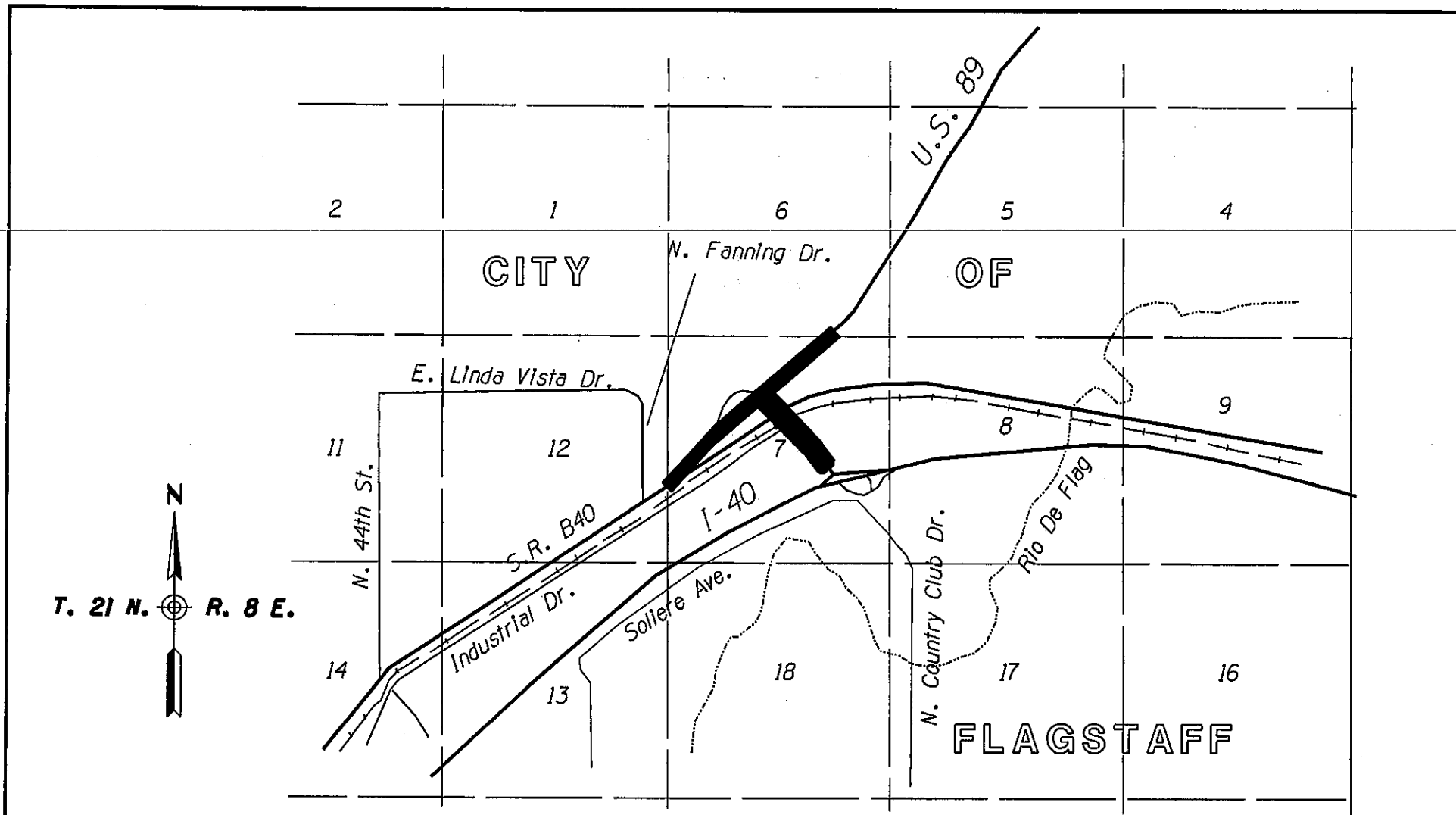

THIS PLAT WAS DIGITALLY PRODUCED
FROM ARIZONA DEPARTMENT OF
TRANSPORTATION
GENERAL HIGHWAY MAP

RIGHT OF WAY PLANS SECTION
REVISED JULY 17, 2000

AREA OF
ESTABLISHMENT

APPENDIX "A"

089 CN 418 H5106 02R / U 089-C-801
FLAGSTAFF - CAMERON
East Flagstaff T. 1.
Coconino County

DATE: MARCH 18, 2005 SHEET: 2 OF 2