

AREA OF ESTABLISHMENT
SEE SHEET 2 OF 2
FOR DETAILS

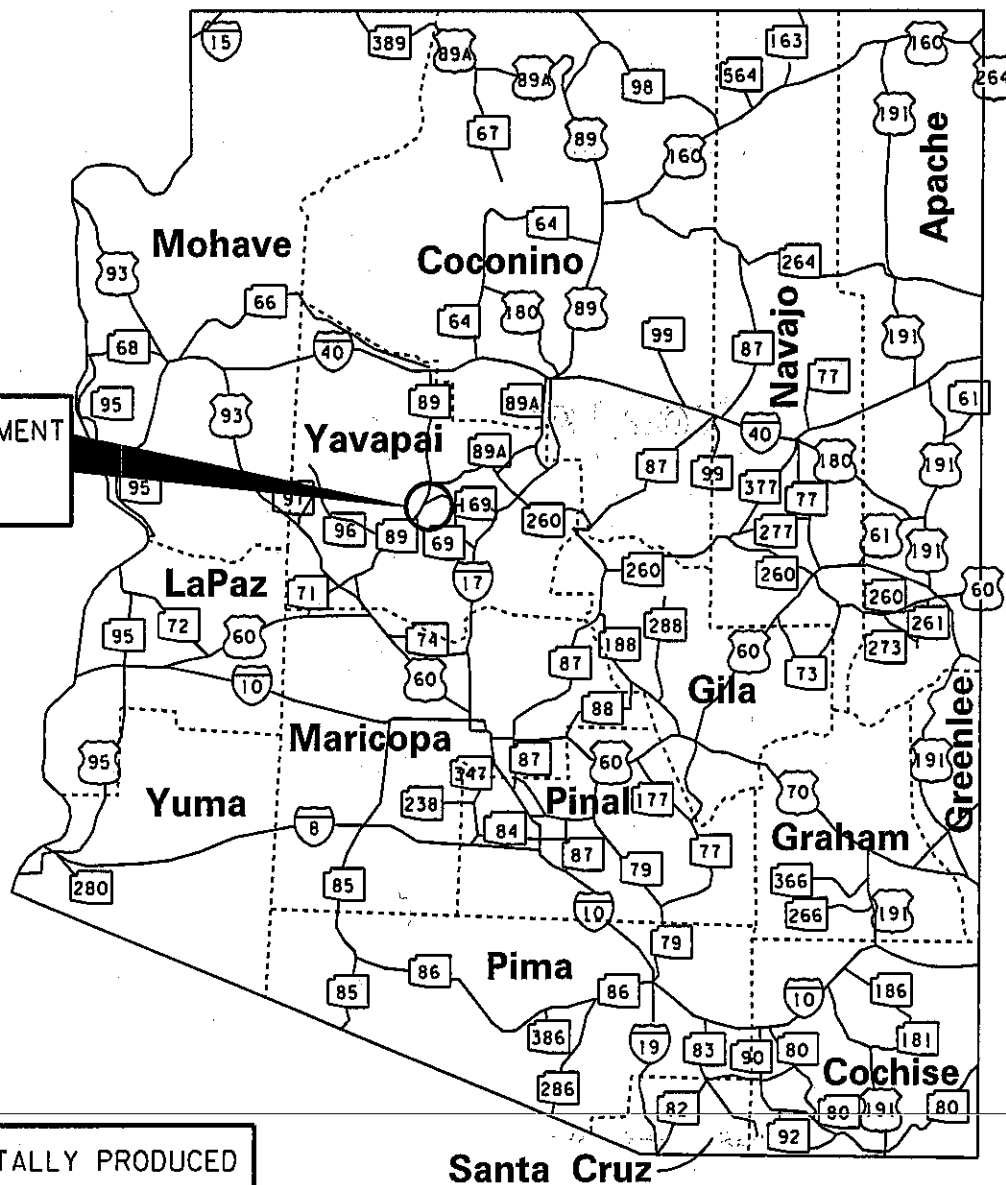

THIS PLAT WAS DIGITALLY PRODUCED
FROM ARIZONA DEPARTMENT OF
TRANSPORTATION
GENERAL HIGHWAY MAP

RIGHT OF WAY PLANS SECTION
REVISED MAY 17, 2000

APPENDIX "A"

089 YV 313 H6187 01R / S 089-B-701
PRESCOTT - ASH FORK
Sundog Ranch Rd. - Willow Lake Rd.
Yavapai County

DATE: FEB 18, 2005 SHEET: 1 OF 2

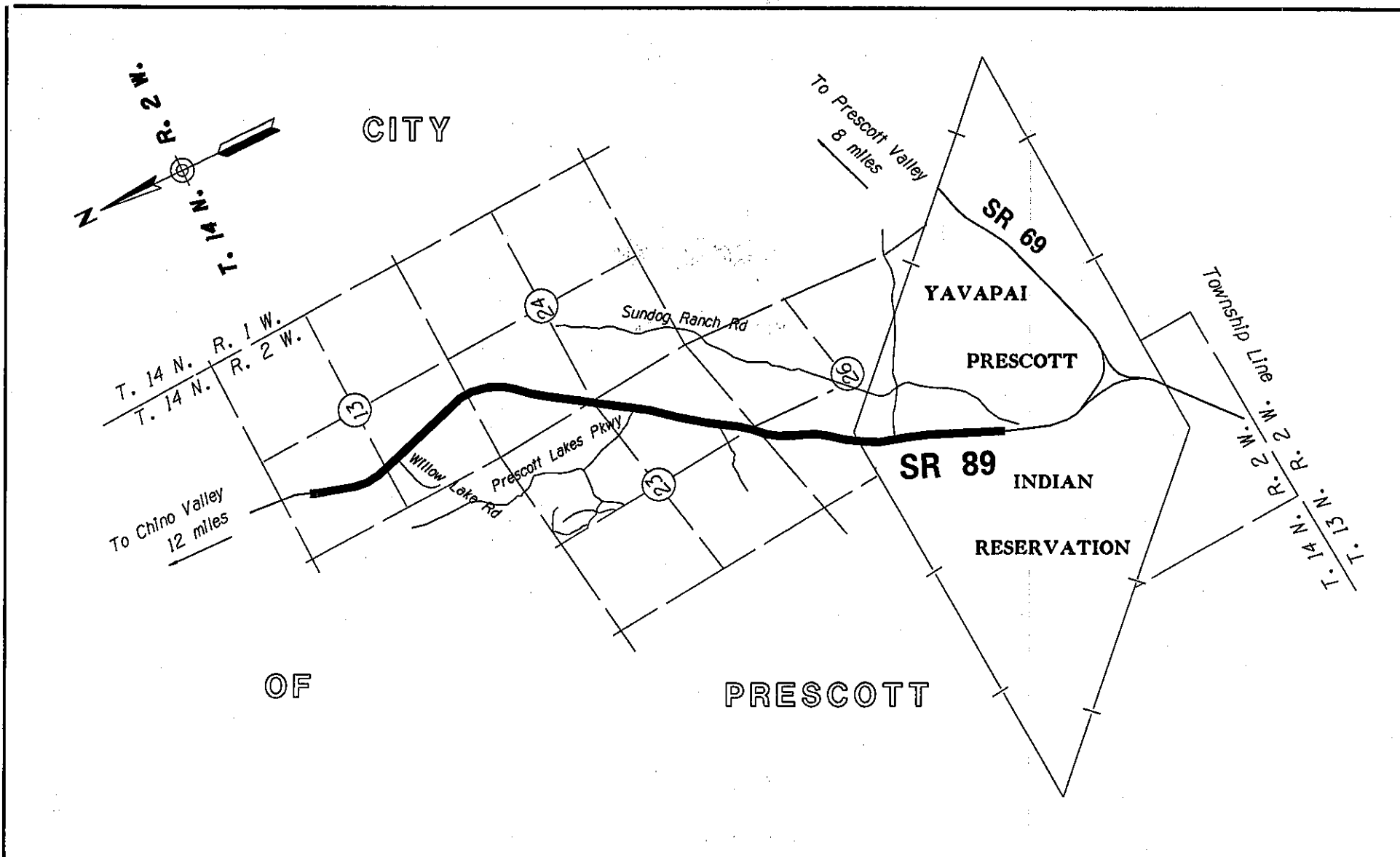

THIS PLAT WAS DIGITALLY PRODUCED
FROM ARIZONA DEPARTMENT OF
TRANSPORTATION
GENERAL HIGHWAY MAP

RIGHT OF WAY PLANS SECTION
REVISED JULY 17, 2000

AREA OF
ESTABLISHMENT

APPENDIX "A"

089 YV 313 H6187 OIR / S 089-B-701
PRESCOTT - ASH FORK
Sundog Ranch Rd. - Willow Lake Rd.
Yavapai County

DATE: FEB 18, 2005 SHEET: 2 OF 2