

Proposed Nelson Reservoir Recreation Improvements

Springerville Ranger District
Apache-Sitgreaves National Forests

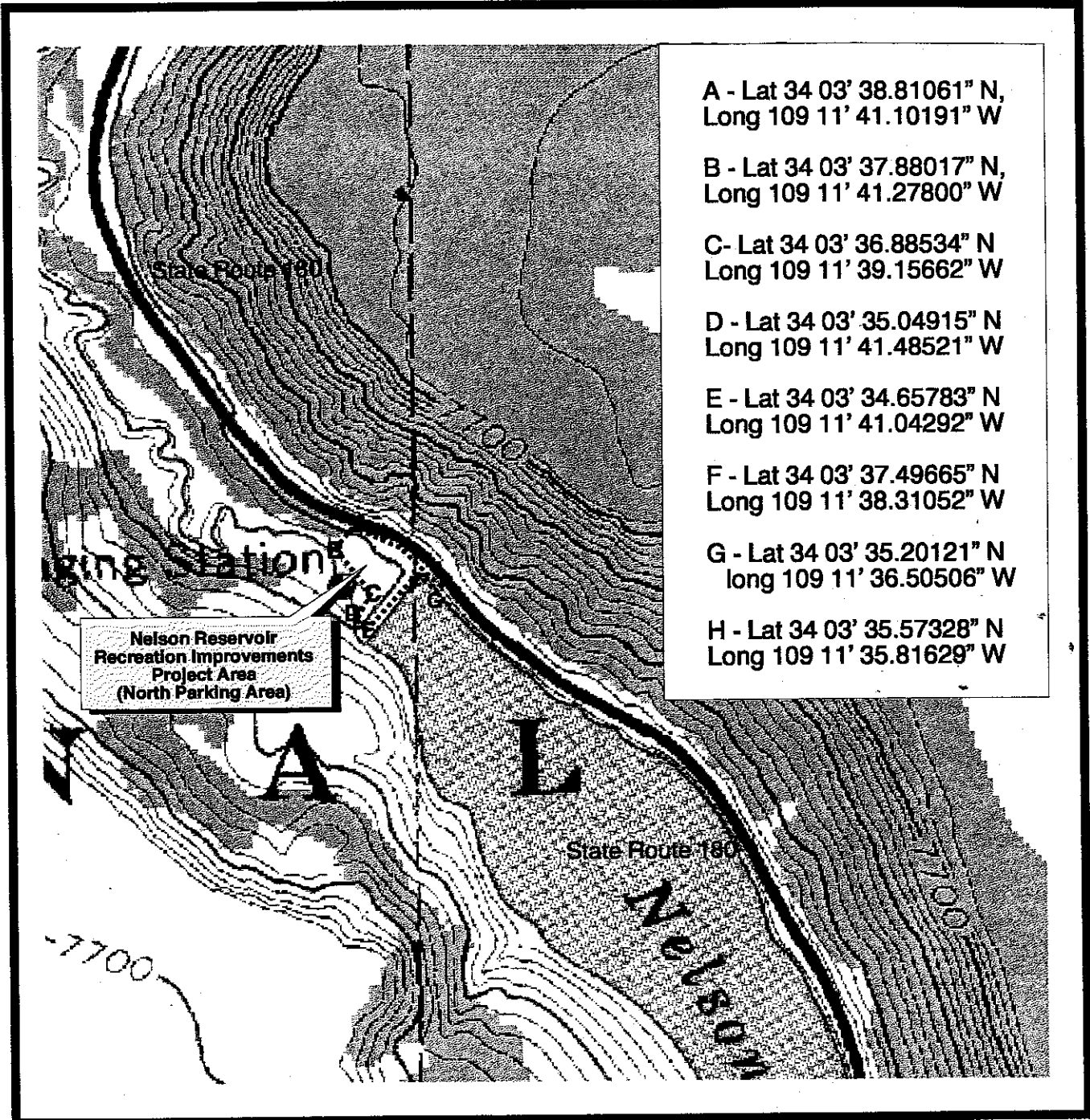

A - Lat 34 03' 38.81061" N,
Long 109 11' 41.10191" W

B - Lat 34 03' 37.88017" N,
Long 109 11' 41.27800" W

C - Lat 34 03' 36.88534" N
Long 109 11' 39.15662" W

D - Lat 34 03' 35.04915" N
Long 109 11' 41.48521" W

E - Lat 34 03' 34.65783" N
Long 109 11' 41.04292" W

F - Lat 34 03' 37.49665" N
Long 109 11' 38.31052" W

G - Lat 34 03' 35.20121" N
long 109 11' 36.50506" W

H - Lat 34 03' 35.57328" N
Long 109 11' 35.81629" W

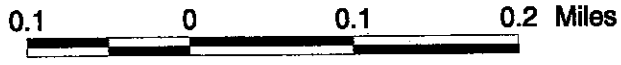

BRomero 10/99

Proposed Nelson Reservoir Recreation Improvements

Springerville Ranger District
Apache-Sitgreaves National Forests

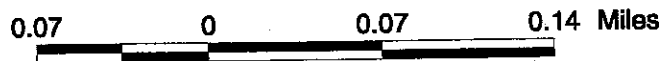
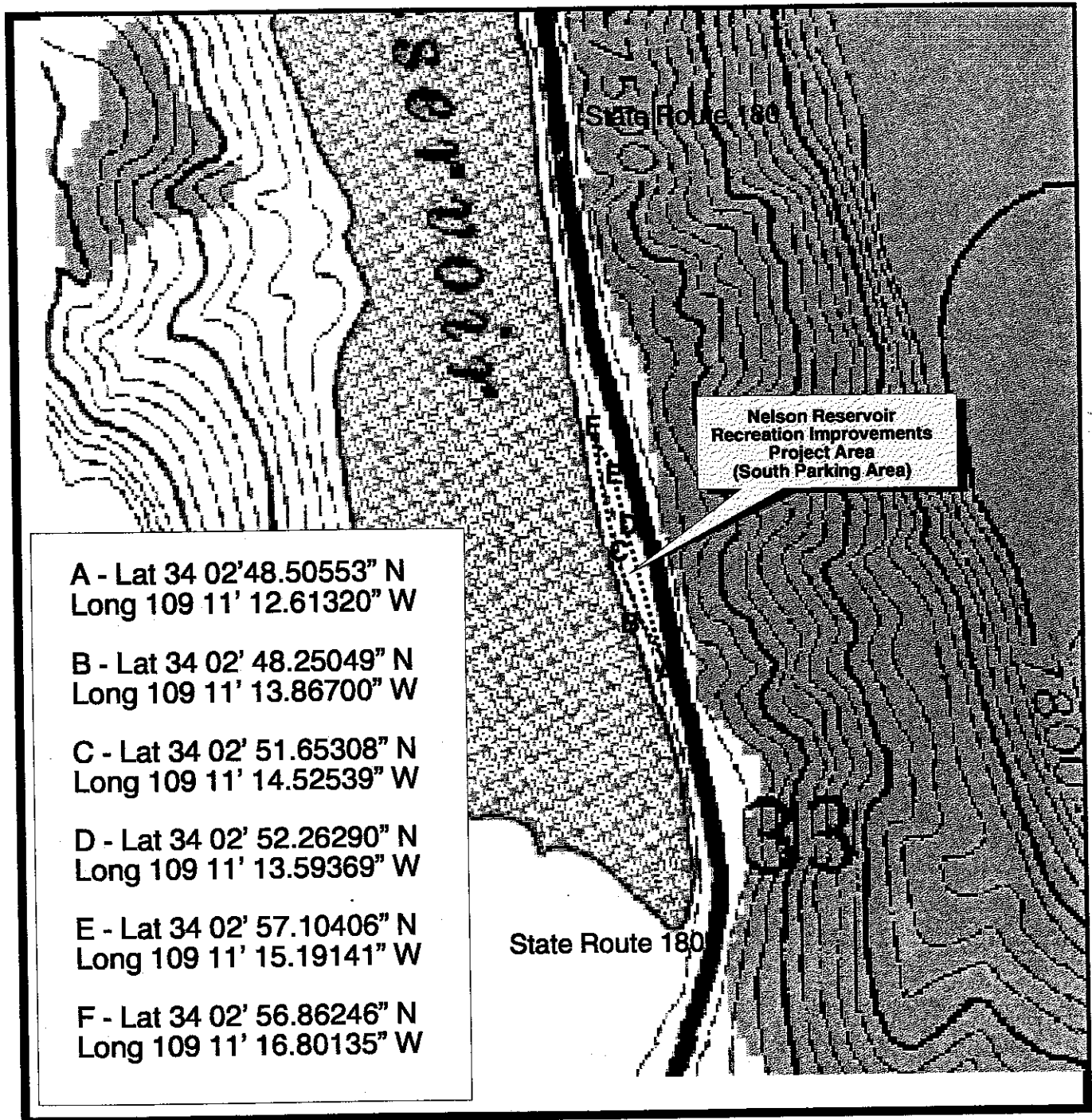

BRomero 10/99

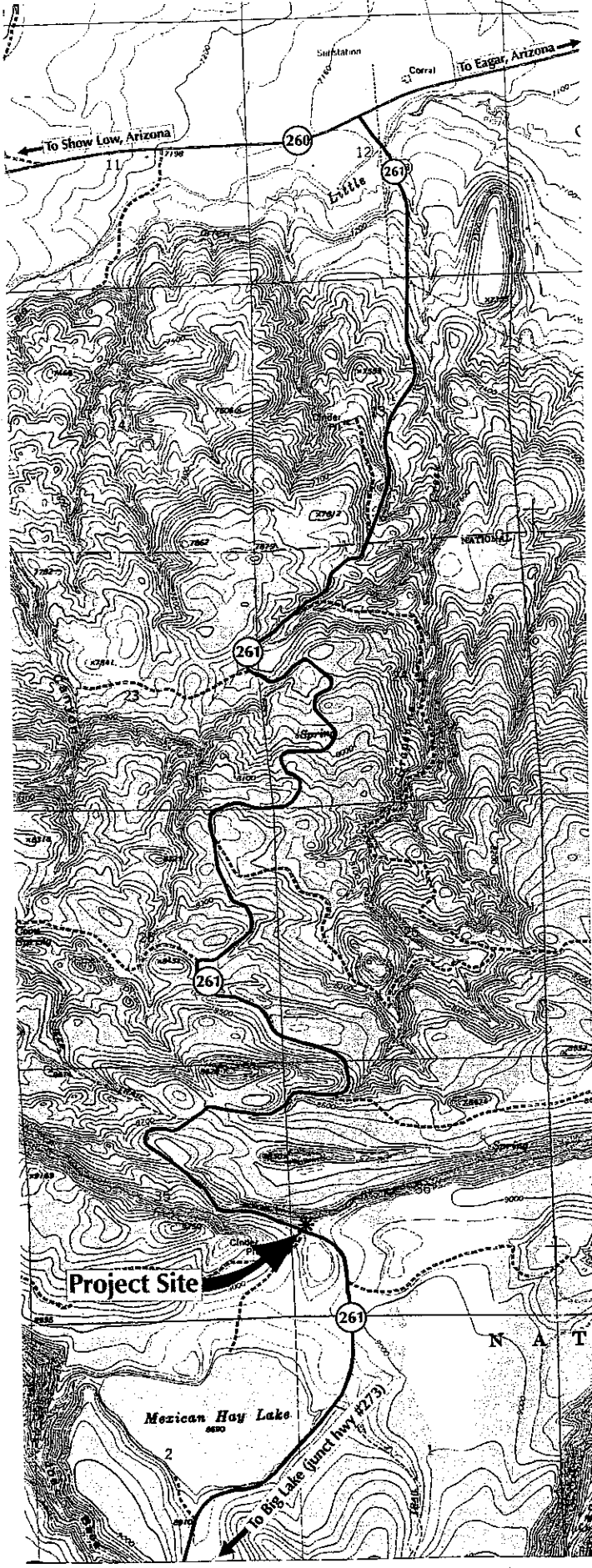

POINT OF THE MOUNTAIN SCENIC OVERLOOK

Project Number: SB-AZ9-9(11)
 TRACS#: 261 AP 405.2 H5388 11C
 Route Name: State Route #261
 White Mountain Scenic Byway

SPRINGVILLE RANGER DISTRICT
 APACHE-SITGREAVES NATIONAL FORESTS

(Map 2)

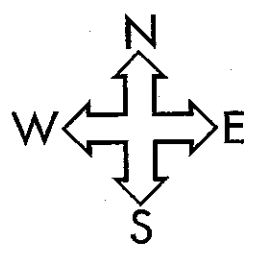

Detail of Project Area

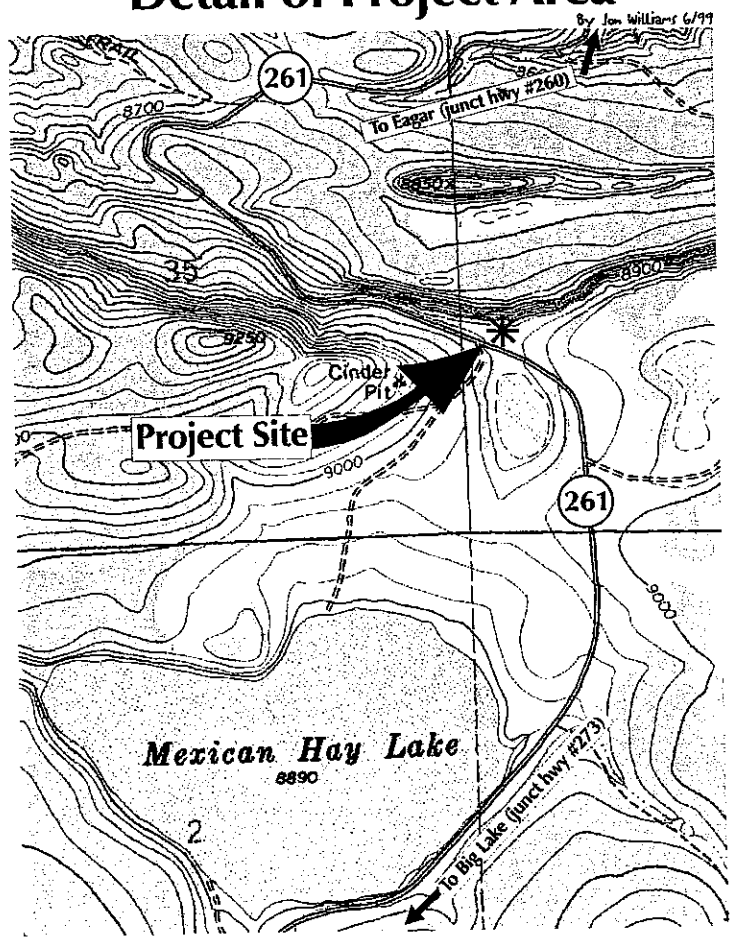

Proposed Point of the Mountain Scenic Overlook
Springerville Ranger District
Apache-Sitgreaves National Forests

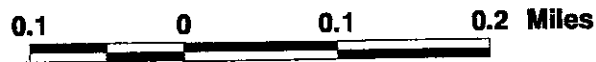
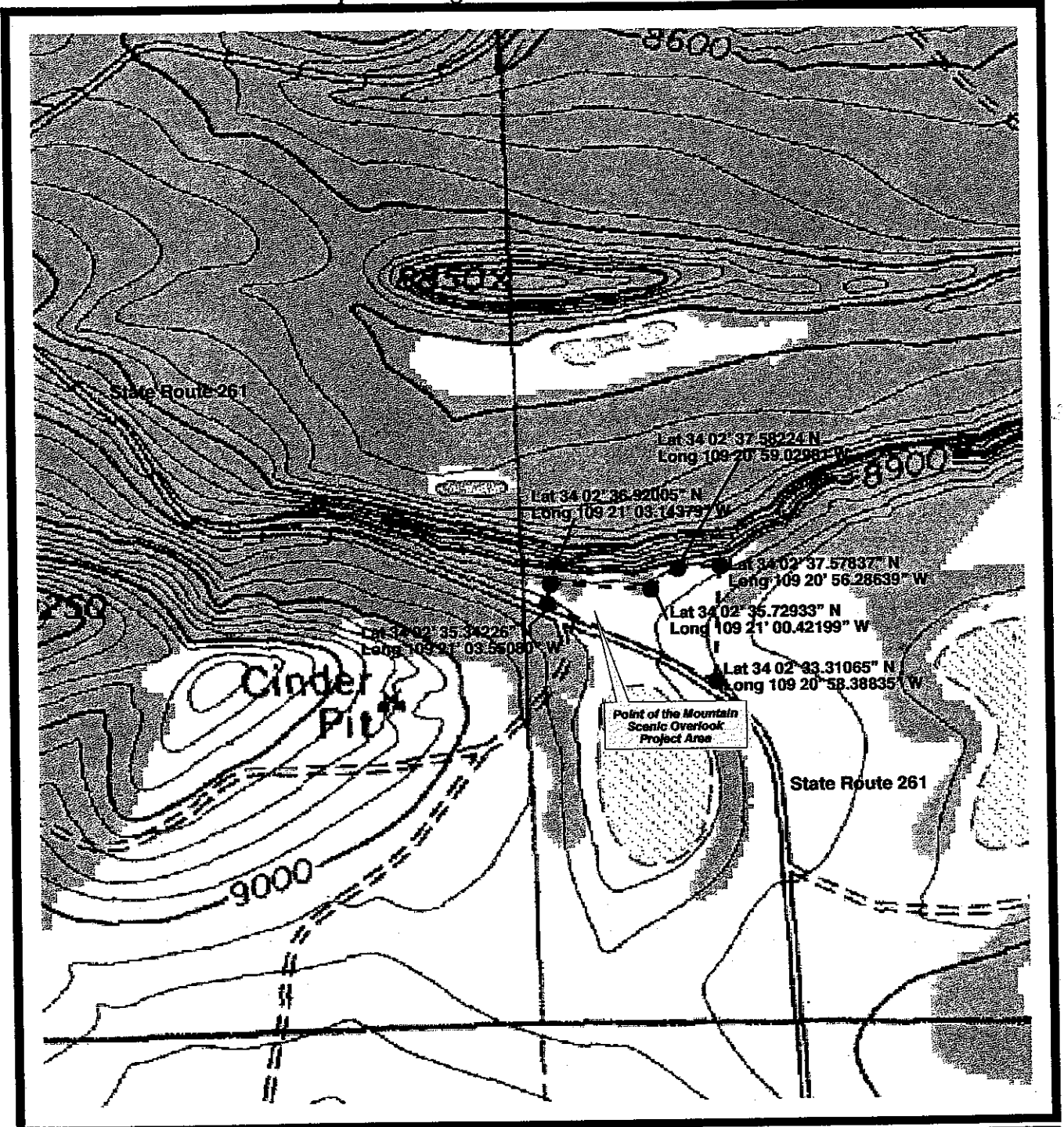

BRomero 10/99

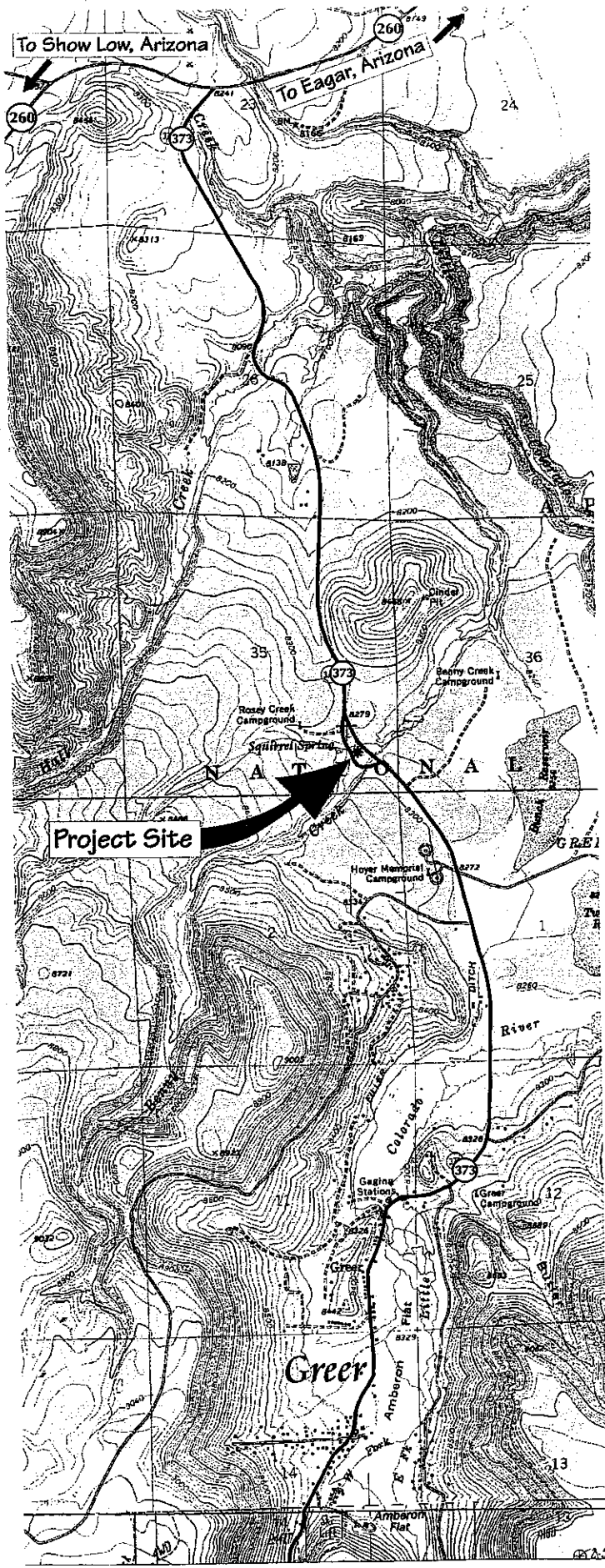

SQUIRREL SPRINGS DAY USE AREA

Project Number: SB-AZ9-9(12)
 TRACS#: 373 AP 388 H5388 12C
 Route Name: State Route #373
White Mountain Scenic Byway

SPRINGVILLE RANGER DISTRICT
 APACHE-SITGREAVES NATIONAL FORESTS

(Map 2)

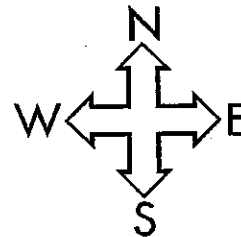

Detail of Project Area

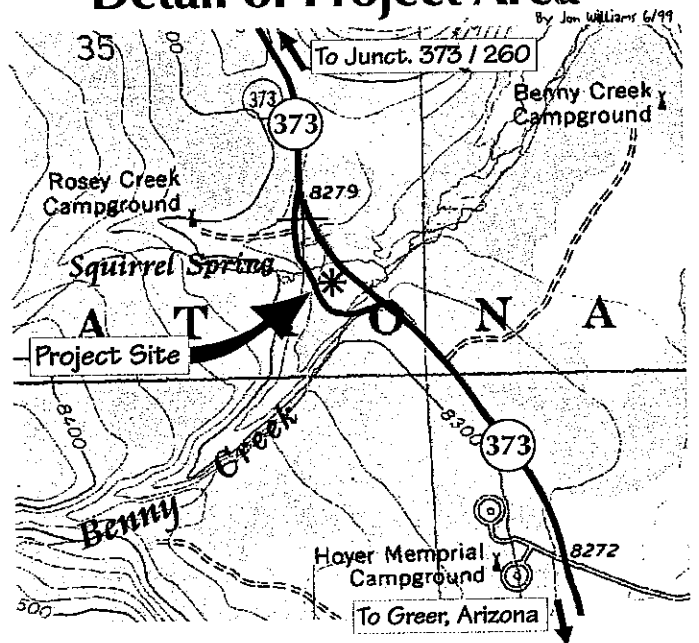

Proposed Squirrel Springs Day Use Area
 Springerville Ranger District
 Apache-Sitgreaves National Forests

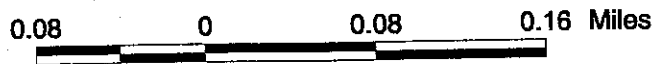
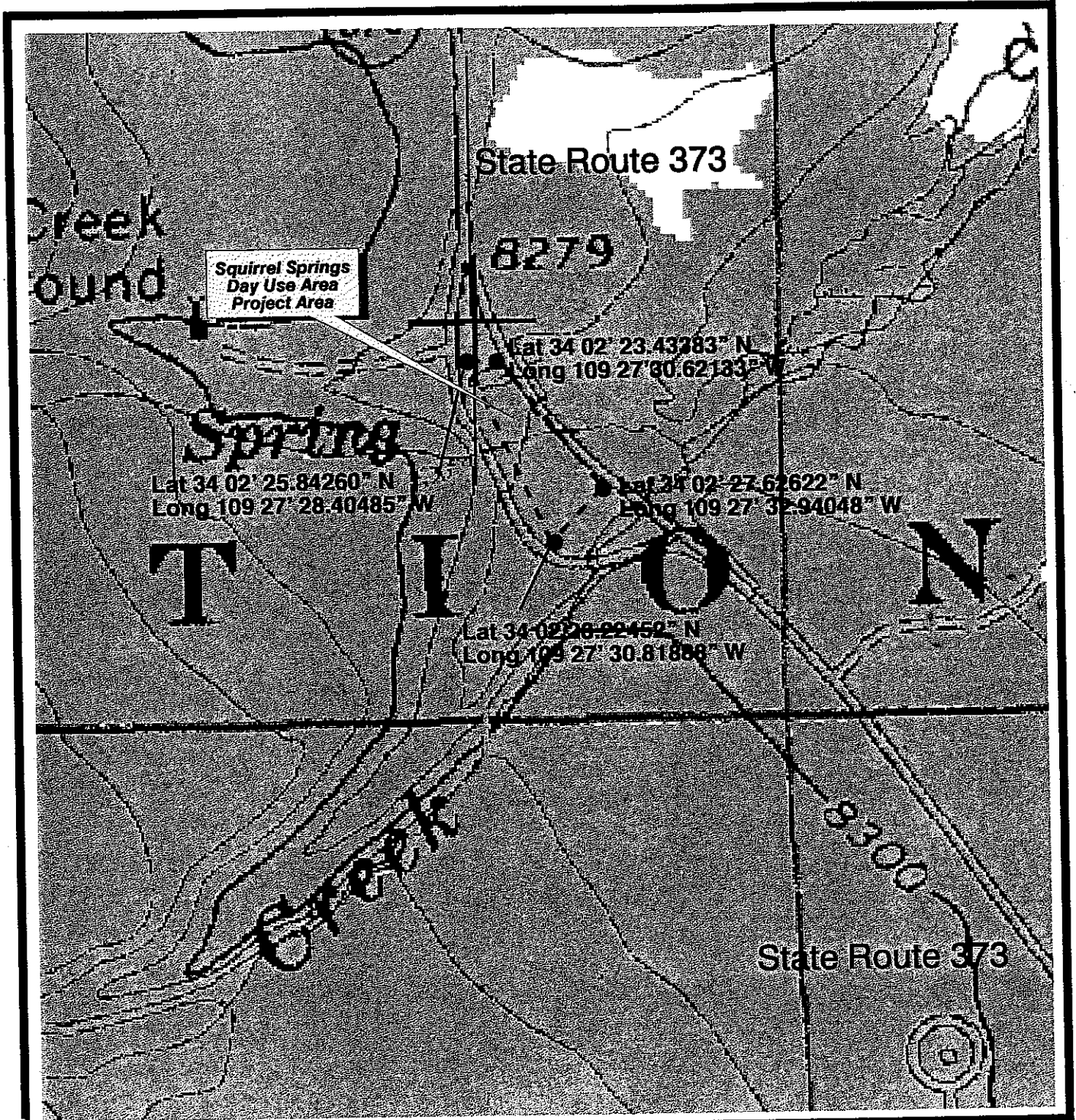

BRomero 10/99