

ARIZONA DEPARTMENT OF TRANSPORTATION
205 SOUTH 17TH AVENUE
R/W Operations, MD 612E
PHOENIX, AZ 85007-3213

December 16, 2011

RES. NO. 2011-12-A-075
PROJECT: 089AYV402.6H5551
HIGHWAY: PRESCOTT - FLAGSTAFF
SECTION: Jct.I-40 - Flagstaff (McDonald's)
ROUTE NO.: State Route 89A
ENG. DIST.: Flagstaff
COUNTY: Coconino
PARCEL NO.: 3-1640

RESOLUTION OF ESTABLISHMENT

JOHN S. HALIKOWSKI, Director, Arizona Department of Transportation, on December 16, 2011, presented and filed with this Transportation Board his written report under Arizona Revised Statutes Section 28-7046, recommending the establishment of donated right of way as a state route and state highway for the improvement of State Route 89A as set forth in the above referenced project.

The donated right of way to be established is depicted in Appendix "A" and delineated on maps and plans on file in the office of the State Engineer, Intermodal Transportation Division, Phoenix, Arizona, entitled "Right of Way Plans, PRESCOTT - FLAGSTAFF Highway, Project 089AYV402.6H5551."

WHEREAS a developer under an ADOT permit has recently constructed turn lanes, which includes gutters, curbs and sidewalks, located at 1401 S. Milton Rd., Flagstaff, Arizona. The new right of way to be donated has been inspected and approved by the ADOT Flagstaff District, and it is now necessary to establish the donated right of way improvements as a state route and state highway; and

WHEREAS because of these premises, this Board finds public safety, necessity and convenience require the recommended establishment of the donated right of way needed for this improvement; therefore, be it

December 16, 2011

RES. NO. 2011-12-A-075
PROJECT: 089AYV402.6H5551
HIGHWAY: PRESCOTT - FLAGSTAFF
SECTION: Jct.I-40 - Flagstaff (McDonald's)
ROUTE NO.: State Route 89A
ENG. DIST.: Flagstaff
COUNTY: Coconino
PARCEL NO.: 3-1640

RESOLVED that the recommendation of the Director is adopted and made part of this resolution; be it further

RESOLVED that the donated right of way depicted in Appendix "A" is hereby designated a state route and state highway, to include any existing county, city or town roadways necessary for or incidental to the improvements as delineated on said maps and plans; be it further

RESOLVED that the Director is hereby authorized to acquire by lawful means pursuant to Arizona Revised Statutes Sections 28-7092 and 28-7094, an estate in fee, or such other interest as required.



89A CN 402.6 H5551
PRESCOTT – FLAGSTAFF HWY
Jct. I-40 – Flagstaff
Coconino County
Dec. 16, 2011 SHEET 1 OF 3

EXHIBIT

ADOT RIGHT OF WAY DEDICATION
AT 1401 S. MILTON ROAD,
FLAGSTAFF, AZ 86001

NOT TO SCALE

WEST 1/4 CORNER, SECTION 21,
T-21N, R-7E, FOUND RAILROAD
RAIL ON SLOPE MARKED WITH "X"

S 63°11'53" E

1246.42'

PARCEL NO. 2

YALE STREET

RIGHT OF WAY
DEDICATION

POINT OF
BEGINNING

MILTON WAY
(U.S. HWY. 89-A)

LINE TABLE		
LINE	BEARINGS	LENGTH
L1	N 88°33'45" E	250.58'
L2	S 01°31'37" E	17.00'
L3	S 01°31'37" E	126.50'
L4	S 88°28'23" W	5.00'
L5	N 01°31'37" W	34.50'
L6	N 88°28'23" E	3.00'
L7	N 01°31'37" W	52.50'
L8	S 88°28'23" W	3.00'
L9	N 01°31'37" W	39.50'
L10	N 88°28'23" E	5.00'

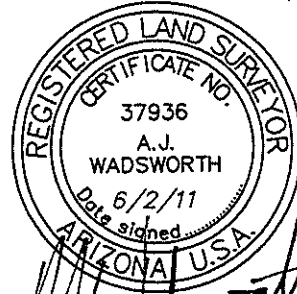

EXPIRES 9/30/2011

APPENDIX "A"

89A CN 402.6 H5551
PRESCOTT - FLAGSTAFF HWY
Jct. I-40 - Flagstaff
Coconino County
Dec. 16, 2011 SHEET 2 OF 3

Superior Surveying Services, Inc.

Professional Land Surveying

21415 North 23rd Avenue, Phoenix, Arizona 85027
Phone (623) 869-0223 Fax (623) 869-0726

REVISIONS		DATE: 6/2/11
DATE	DESCRIPTION	JOB NO.: 101134

DESCRIPTION

ADOT RIGHT OF WAY DEDICATION
AT 1401 S. MILTON ROAD,
FLAGSTAFF, AZ 86001

A portion of Parcel No. 2 as described in that certain Lot Combination recorded in document 3593476, Official Records of Coconino County, Arizona, lying within the Southwest quarter of Section 21, Township 21 North, Range 7 East of the Gila and Salt River, Coconino County, Arizona, and being more particularly described as follows:

COMMENCING at the West quarter corner of said Section 21 marked by a railroad rail marked with an "X";
THENCE South 63 degrees 11 minutes 53 seconds East 1246.42 feet to a point on the North line of said Parcel No. 2 marked by an aluminum cap stamped "ARENCO";
THENCE North 88 degrees 33 minutes 45 seconds East 250.58 feet along the North line of said Parcel No. 2 to the existing West right of way line of U.S. Highway 89-A;
THENCE South 01 degree 31 minutes 37 seconds East 17.00 feet along said existing West right of way line to the POINT OF BEGINNING;
THENCE South 01 degree 31 minutes 37 seconds East 126.50 feet continuing along said existing West right of way line;
THENCE South 88 degrees 28 minutes 23 seconds West 5.00 feet;
THENCE North 01 degree 31 minutes 37 seconds West 34.50 feet;
THENCE North 88 degrees 28 minutes 23 seconds East 3.00 feet;
THENCE North 01 degree 31 minutes 37 seconds West 52.50 feet;
THENCE South 88 degrees 28 minutes 23 seconds West 3.00 feet;
THENCE North 01 degree 31 minutes 37 seconds West 39.50 feet;
THENCE North 88 degrees 28 minutes 23 seconds East 5.00 feet to the POINT OF BEGINNING.

Comprising 0.011 acres or 475 square feet more or less, subject to all easements of record.

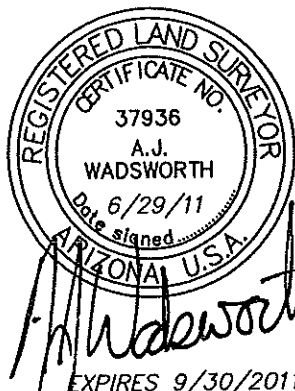

APPENDIX "A"

89A CN 402.6 H5551
PRESCOTT - FLAGSTAFF HWY
Jct. I-40 - Flagstaff
Coconino County
Dec. 16, 2011 SHEET 3 OF 3

Superior Surveying Services, Inc.

Professional Land Surveying

21415 North 23rd Avenue, Phoenix, Arizona 85027
Phone (623) 869-0223 Fax (623) 869-0726

REVISIONS		DATE: 6/2/11
DATE	DESCRIPTION	JOB NO.: 101134
6/27/11	Revised per ADOT comments	
6/29/11	Corrected "+" to "X"	

December 16, 2011

RES. NO. 2011-12-A-075
PROJECT: 089AYV402.6H5551
HIGHWAY: PRESCOTT - FLAGSTAFF
SECTION: Jct.I-40 - Flagstaff (McDonald's)
ROUTE NO.: State Route 89A
ENG. DIST.: Flagstaff
COUNTY: Coconino
PARCEL NO.: 3-1640

REPORT AND RECOMMENDATION

TO THE HONORABLE ARIZONA TRANSPORTATION BOARD:

The Intermodal Transportation Division has made a thorough investigation concerning the establishment and improvement of a portion of State Route 89A within the above referenced project.

The existing alignment was previously established as a state route in the Official Minutes of the Arizona Highway Commission Resolution dated May 23, 24, & 25, 1934, page 625, designated State Route 79; Resolution dated June 18, 1934, page 692, established State Route 79 as a state highway; thereafter, Arizona Department of Transportation Board Resolution 93-02-A-08, dated March 19, 1993, renumbered and redesignated as State Route 89A.

A developer under an ADOT permit has recently constructed turn lanes, which includes gutters, curbs and sidewalks, located at 1401 S. Milton Rd., Flagstaff, Arizona. The new right of way to be donated has been inspected and approved by the ADOT Flagstaff District, and it is now necessary to establish the donated right of way improvements as a state route and state highway. Accordingly, it is necessary to establish and acquire the donated right of way for this project.

The donated right of way to be established as a state route and state highway is depicted in Appendix "A" and delineated on maps and plans on file in the office of the State Engineer, Intermodal Transportation Division, Phoenix, Arizona, entitled "Right of Way Plans, PRESCOTT - FLAGSTAFF Highway, Project 089AYV402.6H5551."

December 16, 2011

RES. NO. 2011-12-A-075
PROJECT: 089AYV402.6H5551
HIGHWAY: PRESCOTT - FLAGSTAFF
SECTION: Jct.I-40 - Flagstaff (McDonald's)
ROUTE NO.: State Route 89A
ENG. DIST.: Flagstaff
COUNTY: Coconino
PARCEL NO.: 3-1640

In the interest of public safety, necessity and convenience, I recommend that the donated right of way depicted in Appendix "A" be established as a state route and state highway.

Pursuant to Arizona Revised Statutes Section 28-7046, I recommend the adoption of a resolution making this recommendation effective.

Respectfully submitted,

A handwritten signature in black ink, appearing to read "John S. Halikowski". The signature is fluid and cursive, with a large initial "J" and "H".

JOHN S. HALIKOWSKI, Director
Arizona Department of Transportation

December 16, 2011

RES. NO. 2011-12-A-075
PROJECT: 089AYV402.6H5551
HIGHWAY: PRESCOTT - FLAGSTAFF
SECTION: Jct.I-40 - Flagstaff (McDonald's)
ROUTE NO.: State Route 89A
ENG. DIST.: Flagstaff
COUNTY: Coconino
PARCEL NO.: 3-1640

CERTIFICATION

I, JOHN S. HALIKOWSKI, Director of the Arizona Department of Transportation, do hereby certify that the foregoing is a true and correct copy from the minutes of the Transportation Board made in official session on December 16, 2011.

IN WITNESS WHEREOF, I have hereunto set my hand and the official seal of the Transportation Board on December 16, 2011.

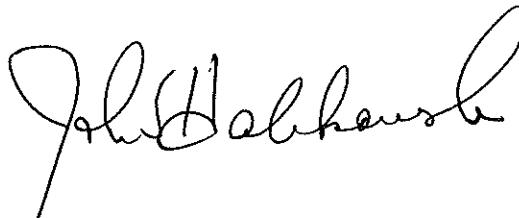
A handwritten signature in black ink, appearing to read "John Halikowski", with a large, stylized initial "J" and a long, sweeping underline.

JOHN S. HALIKOWSKI, Director
Arizona Department of Transportation

APPROVED

Ron J. Aschenbach

Assistant Attorney General
Attorney for Department
of Transportation

Date 12/1/11