

ARIZONA DEPARTMENT OF TRANSPORTATION
205 SOUTH 17TH AVENUE
R/W Operations, MD 612E
PHOENIX, AZ 85007-3213

October 15, 2010

RES. NO. 2010-10-A-082
PROJECT: 089YV289H773201R
HIGHWAY: WICKENBURG - PRESCOTT
SECTION: Kirkland Jct. - M.P.
ROUTE NO.: State Route 89
ENG. DIST.: Prescott
COUNTY: Yavapai

RESOLUTION OF ESTABLISHMENT

JOHN S. HALIKOWSKI, Director, Arizona Department of Transportation, on October 15, 2010, presented and filed with this Transportation Board his written report under Arizona Revised Statutes Section 28-7046, recommending the establishment and acquisition of new right of way for the improvement of State Route 89 as set forth in the above referenced project.

The new right of way to be established and acquired for this improvement is depicted in Appendix "A" and delineated on maps and plans on file in the office of the State Engineer, Intermodal Transportation Division, Phoenix, Arizona, entitled "95% Design Plans, dated August 9, 2010, WICKENBURG - PRESCOTT Highway."

WHEREAS establishment and acquisition of the new right of way is necessary for this improvement, and includes authorization pursuant to Arizona Revised Statutes Sections 28-7092 and 28-7094 an estate in fee, or such other interest as required, to include advance, future and early acquisition, exchanges, donations and material for construction, haul roads and various easements in any property necessary for or incidental to the improvements as delineated on said maps and plans; and

WHEREAS because of these premises, this Board finds public safety, necessity and convenience require the recommended establishment and acquisition of the new right of way needed for this improvement; therefore, be it

RESOLVED that the recommendation of the Director is adopted and made part of this resolution; be it further

October 15, 2010

RES. NO. 2010-10-A-082
PROJECT: 089YV289H773201R
HIGHWAY: WICKENBURG - PRESCOTT
SECTION: Kirkland Jct. - M.P. 293
ROUTE NO.: State Route 89
ENG. DIST.: Prescott
COUNTY: Yavapai

RESOLVED that the right of way as depicted in Appendix "A" is hereby designated a state route and that prior to construction the new right of way shall be established as a state highway; be it further

RESOLVED that the Director is hereby authorized to acquire by lawful means pursuant to Arizona Revised Statutes Sections 28-7092 and 28-7094 an estate in fee, or such other interest as required, to include advance, future and early acquisition, exchanges, donations and material for construction, haul roads, and various easements in any property necessary for or incidental to the improvements as delineated on said maps and plans; be it further

RESOLVED that the Director secure an appraisal of the property to be acquired and that necessary parties be compensated. Upon failure to acquire said lands by other lawful means, the Director is authorized to initiate condemnation proceedings.

AREA OF ESTABLISHMENT
SEE SHEET 2 OF 2
FOR DETAILS

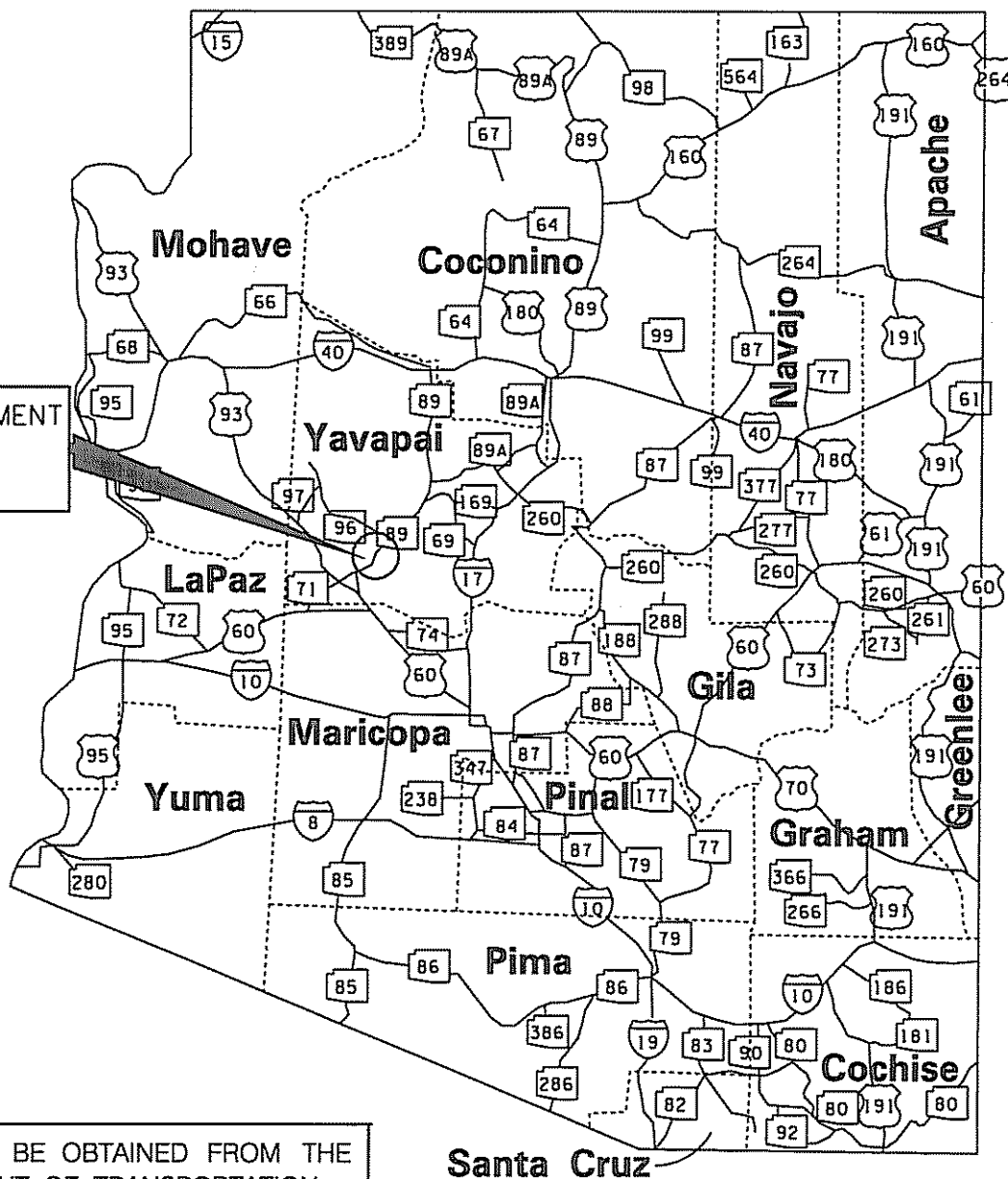

A LEGIBLE COPY CAN BE OBTAINED FROM THE
ARIZONA DEPARTMENT OF TRANSPORTATION
STATE ENGINEERS OFFICE
LOCATED AT:
206 SOUTH 17TH AVENUE
PHOENIX, ARIZONA 85007
MAIL DROP 102A

APPENDIX "A"

089 YV 289 H7732 01R
WICKENBURG - PRESCOTT HWY
Unassigned
Kirkland Junction - MP 293
Yavapai County

DATE: OCT 15, 2010 SHEET 1 OF 2

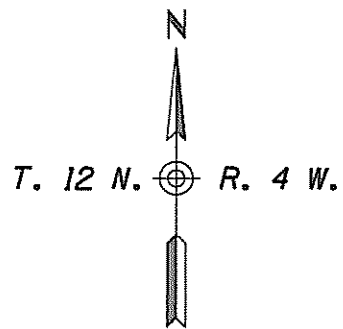

Section 22

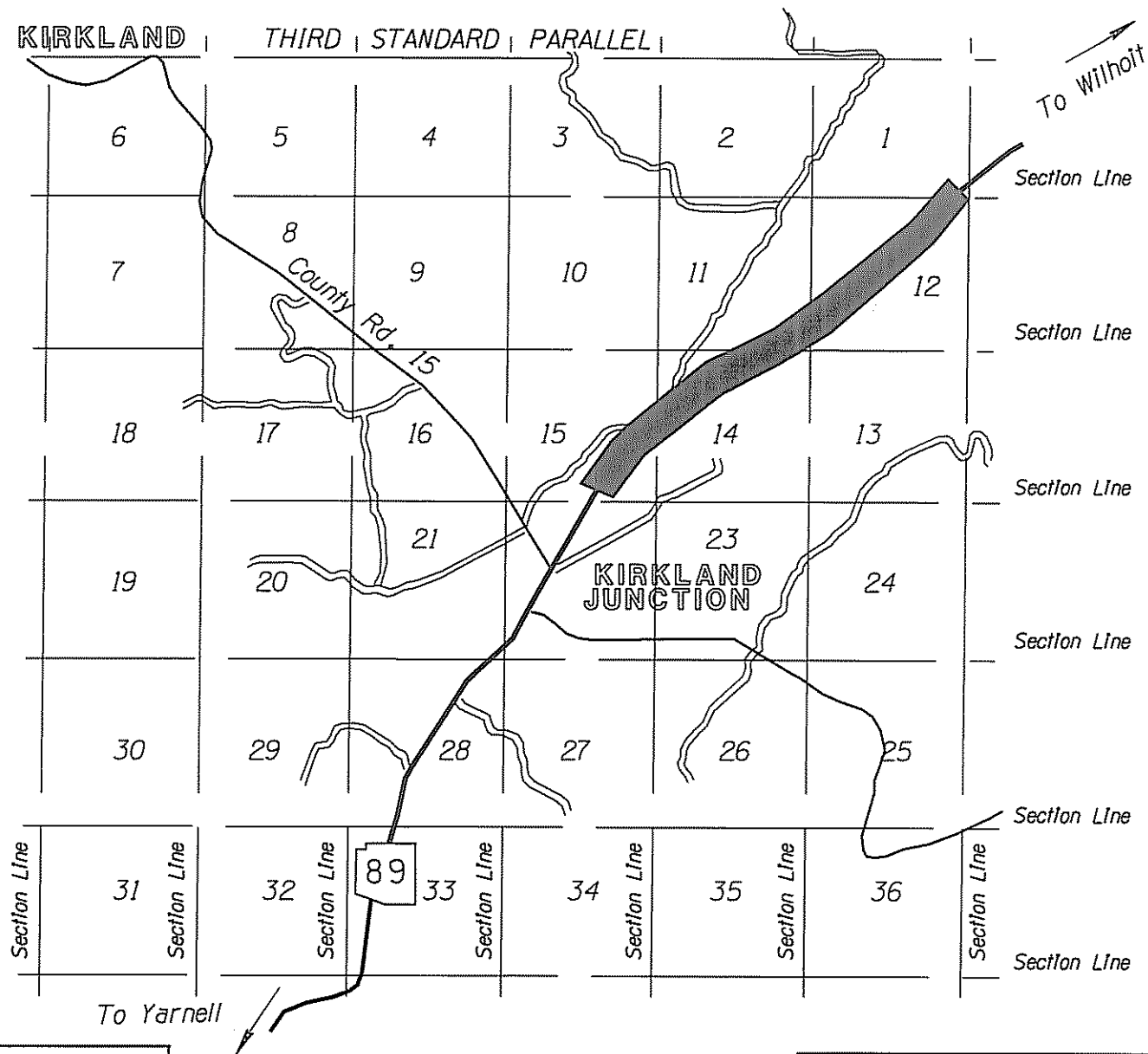

A LEGIBLE COPY CAN BE OBTAINED FROM THE
ARIZONA DEPARTMENT OF TRANSPORTATION
STATE ENGINEERS OFFICE
LOCATED AT:
206 SOUTH 17TH AVENUE
PHOENIX, ARIZONA 85007
MAIL DROP 102A

AREA OF
ESTABLISHMENT

APPENDIX "A"

089 YV 289 H7732 01R
WICKENBURG – PRESCOTT HWY
Unassigned
Kirkland Junction – MP 293
Yavapai County

DATE: OCT 15, 2010 SHEET 2 OF 2

October 15, 2010

RES. NO. 2010-10-A-082
PROJECT: 089YV289H773201R
HIGHWAY: WICKENBURG - PRESCOTT
SECTION: Kirkland Jct. - M.P. 293
ROUTE NO.: State Route 89
ENG. DIST.: Prescott
COUNTY: Yavapai

REPORT AND RECOMMENDATION

TO THE HONORABLE ARIZONA TRANSPORTATION BOARD:

The Intermodal Transportation Division has made a thorough investigation concerning the establishment and improvement of State Route 89 within the above referenced project.

The existing alignment was previously established by Resolution of the Arizona State Highway Commission in the Official Minutes of September 9, 1927 at page 26; thereafter Arizona Transportation Board Resolution 85-04-A-08 dated April 26, 1985, established additional right of way for intersection improvements; various Resolutions established additional right of way for improvements thereof.

New right of way is now needed for drainage improvements. Accordingly, it is necessary to establish and acquire the new right of way for this improvement project.

The new right of way to be established and acquired for the improvements is depicted in Appendix "A" and delineated on maps and plans on file in the office of the State Engineer, Intermodal Transportation Division, Phoenix, Arizona, entitled "95% Design Plans, dated August 9, 2010, WICKENBURG - PRESCOTT Highway."

In the interest of public safety, necessity and convenience, I recommend that the new right of way depicted in Appendix "A" be established and improved as a state route and that prior to construction the new right of way shall be established as a state highway.

October 15, 2010

RES. NO. 2010-10-A-082
PROJECT: 089YV289H773201R
HIGHWAY: WICKENBURG - PRESCOTT
SECTION: Kirkland Jct. - M.P. 293
ROUTE NO.: State Route 89
ENG. DIST.: Prescott
COUNTY: Yavapai

I further recommend the acquisition of the new right of way pursuant to Arizona Revised Statutes Sections 28-7092 and 28-7094, an estate in fee, or such other interest as required, including advance, future and early acquisition, exchanges, donations or such other interest as is required, including material for construction, haul roads and various easements necessary for or incidental to the improvements as delineated on said maps and plans.

Pursuant to Arizona Revised Statutes Section 28-7046, I recommend the adoption of a resolution making this recommendation effective.

Respectfully submitted,

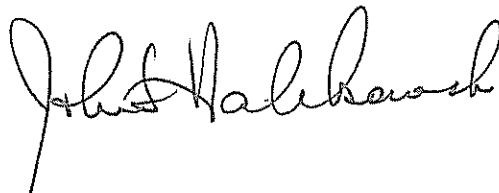
A handwritten signature in black ink, appearing to read "John S. Halikowski". The signature is fluid and cursive, with a long vertical line extending downwards from the bottom of the name.

JOHN S. HALIKOWSKI, Director
Arizona Department of Transportation

October 15, 2010

RES. NO. 2010-10-A-082
PROJECT: 089YV289H773201R
HIGHWAY: WICKENBURG - PRESCOTT
SECTION: Kirkland Jct. - M.P. 293
ROUTE NO.: State Route 89
ENG. DIST.: Prescott
COUNTY: Yavapai

CERTIFICATION

I, JOHN S. HALIKOWSKI, Director of the Arizona Department of Transportation, do hereby certify that the foregoing is a true and correct copy from the minutes of the Transportation Board made in official session on October 15, 2010.

IN WITNESS WHEREOF I have hereunto set my hand and the official seal of the Transportation Board on October 15, 2010.



JOHN S. HALIKOWSKI, Director
Arizona Department of Transportation

2010 OCT 15 PM 4:11
ARIZONA DEPARTMENT OF TRANSPORTATION
OFFICE OF THE DIRECTOR
1500 W. WASHINGTON AVENUE
PHOENIX, AZ 85007
TEL: 602.971.2000
WWW.AZDOT.ORG