

ARIZONA DEPARTMENT OF TRANSPORTATION
205 SOUTH 17TH AVENUE
R/W Operations, MD 612E
PHOENIX, AZ 85007-3213

November 18, 2005

RES. NO. 2005-11-A-059
PROJECT: N-810-601 / 191GH113H088801R
HIGHWAY: BOWIE JCT. - SAFFORD
SECTION: Swift Trail Junction
ROUTE NO.: U.S. Route 191
ENG. DIST.: Safford
COUNTY: Graham
PARCEL: 5-0464

RESOLUTION OF ESTABLISHMENT

VICTOR M. MENDEZ, Director, Arizona Department of Transportation, on November 18, 2005, presented and filed with this Transportation Board his written report under Arizona Revised Statutes Section 28-7046, recommending the establishment and acquisition of additional right of way for a portion of U.S. Route 191 as set forth in the above referenced project.

The additional right of way to be established and acquired is depicted in Appendix "A" and delineated on maps and plans on file in the office of the State Engineer, Intermodal Transportation Division, Phoenix, Arizona, entitled "Right of Way Plans, BOWIE JCT. - SAFFORD Highway, Project N-810-601 / 191GH113H088801R."

WHEREAS in a remedial effort to acquire additional right of way which was previously thought to have been acquired, establishment and acquisition of said additional right of way is now necessary; and

WHEREAS because of these premises, this Board finds public safety, necessity and convenience require the recommended establishment and acquisition of the additional land; therefore, be it

RESOLVED that the recommendation of the Director is adopted and made part of this resolution; be it further

ARIZONA DEPARTMENT OF TRANSPORTATION
205 SOUTH 17TH AVENUE
R/W Operations, MD 612E
PHOENIX, AZ 85007-3213

November 18, 2005

RES. NO. 2005-11-A-059
PROJECT: N-810-601 / 191GH113H088801R
HIGHWAY: BOWIE JCT. - SAFFORD
SECTION: Swift Trail Junction
ROUTE NO.: U.S. Route 191
ENG. DIST.: Safford
COUNTY: Graham
PARCEL: 5-0464

RESOLUTION OF ESTABLISHMENT

VICTOR M. MENDEZ, Director, Arizona Department of Transportation, on November 18, 2005, presented and filed with this Transportation Board his written report under Arizona Revised Statutes Section 28-7046, recommending the establishment and acquisition of additional right of way for a portion of U.S. Route 191 as set forth in the above referenced project.

The additional right of way to be established and acquired is depicted in Appendix "A" and delineated on maps and plans on file in the office of the State Engineer, Intermodal Transportation Division, Phoenix, Arizona, entitled "Right of Way Plans, BOWIE JCT. - SAFFORD Highway, Project N-810-601 / 191GH113H088801R."

WHEREAS in a remedial effort to acquire additional right of way which was previously thought to have been acquired, establishment and acquisition of said additional right of way is now necessary; and

WHEREAS because of these premises, this Board finds public safety, necessity and convenience require the recommended establishment and acquisition of the additional land; therefore, be it

RESOLVED that the recommendation of the Director is adopted and made part of this resolution; be it further

November 18, 2005

RES. NO. 2005-11-A-059
PROJECT: N-810-601 / 191GH113H088801R
HIGHWAY: BOWIE JCT. - SAFFORD
SECTION: Swift Trail Junction
ROUTE NO.: U.S. Route 191
ENG. DIST.: Safford
COUNTY: Graham
PARCEL: 5-0464

RESOLVED that the portion of right of way as depicted in Appendix "A" is hereby designated a state route and state highway; be it further

RESOLVED that the Director is hereby authorized to acquire by lawful means, including exchanges, in accordance with Arizona Revised Statutes Section 28-7092, an estate in fee, or such other interest as is required; be it further

RESOLVED that the Director secure an appraisal of the property to be acquired and that necessary parties be compensated. Upon failure to acquire said lands by other lawful means, the Director is authorized to initiate condemnation proceedings.

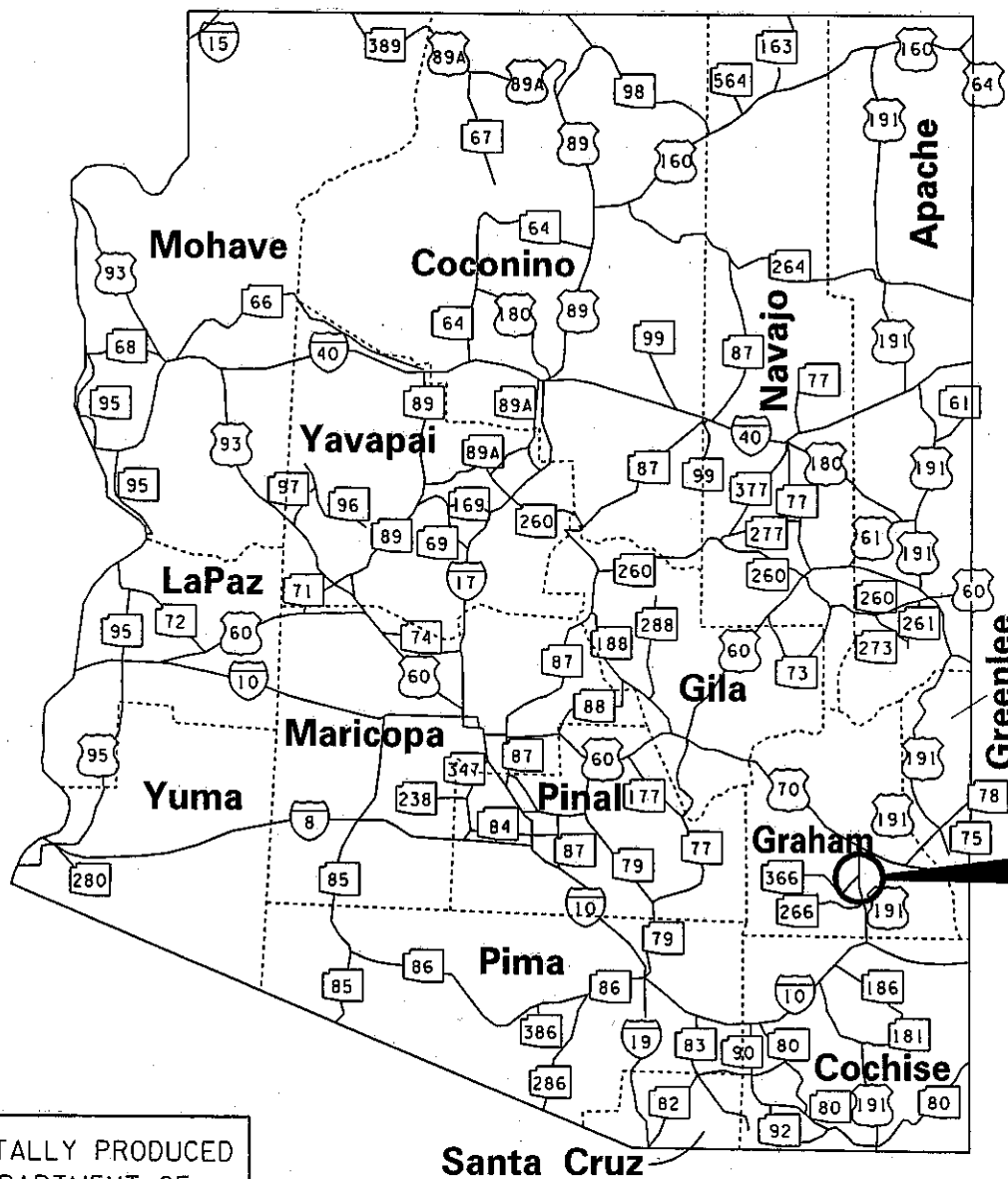

AREA OF ESTABLISHMENT
SEE SHEET 2 OF 2
FOR DETAILS

THIS PLAT WAS DIGITALLY PRODUCED
FROM ARIZONA DEPARTMENT OF
TRANSPORTATION
GENERAL HIGHWAY MAP

RIGHT OF WAY PLANS SECTION
REVISED MAY 17, 2000

APPENDIX "A"

191 GH 113 H0888 01R / N 810-601
BOWIE JCT - SAFFORD US 191
Swift Trail Junction
Graham County

DATE: NOV 18, 2005 SHEET: 1 OF 2

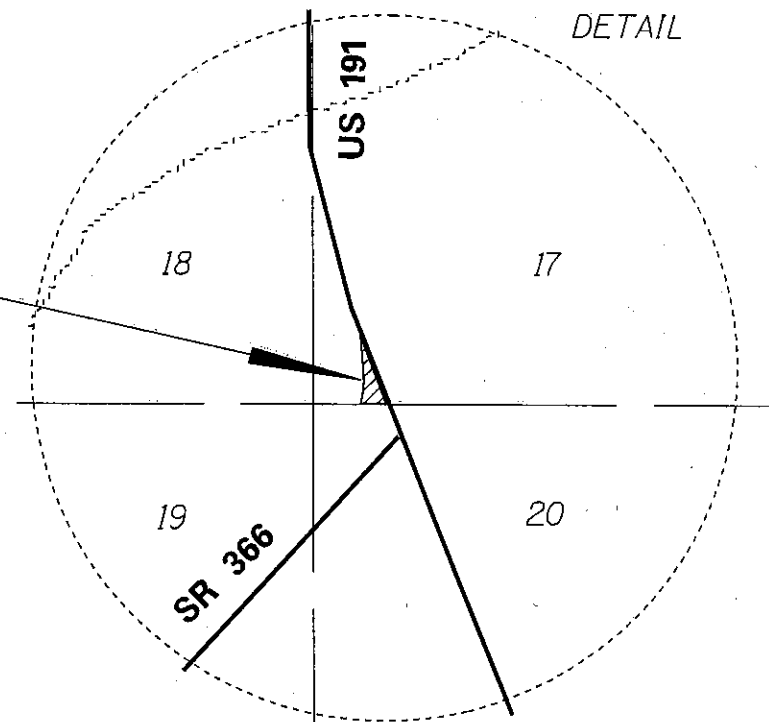
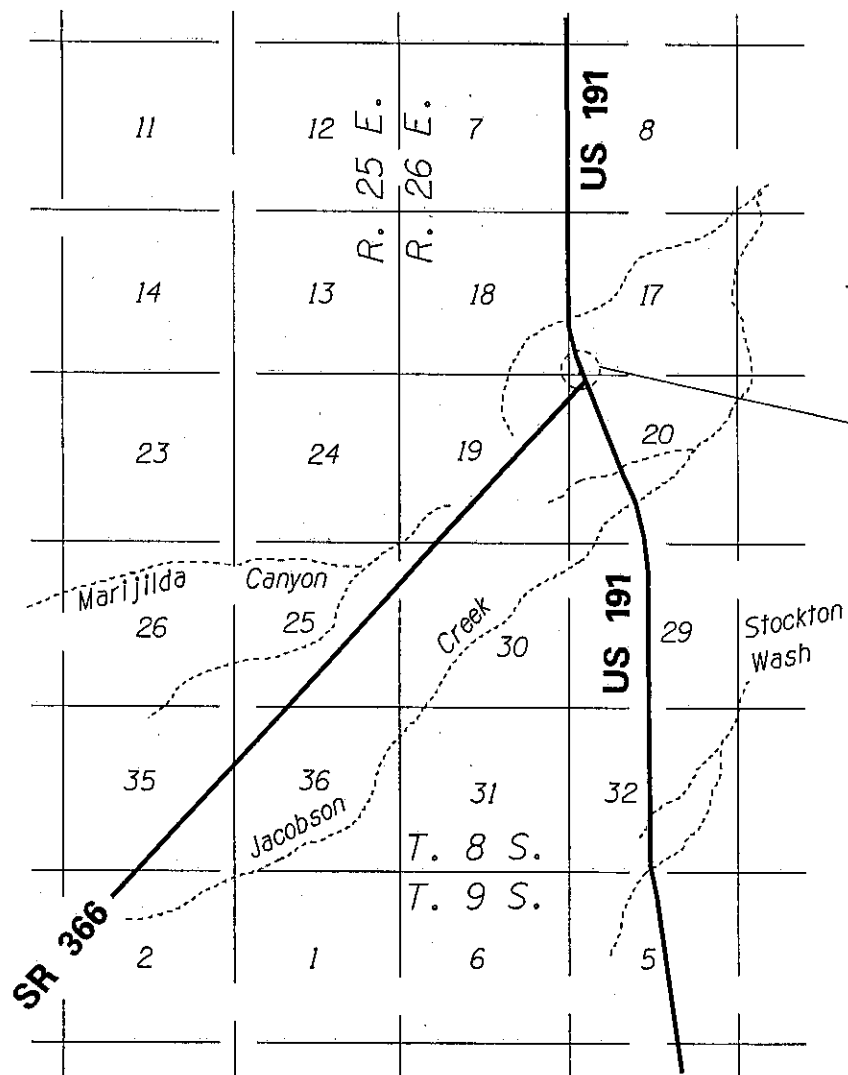

THIS PLAT WAS DIGITALLY PRODUCED
FROM ARIZONA DEPARTMENT OF
TRANSPORTATION
GENERAL HIGHWAY MAP

RIGHT OF WAY PLANS SECTION
REVISED JULY 17, 2000

AREA OF
ESTABLISHMENT



APPENDIX "A"

191 GH 113 H0888 01R / N 810-601
BOWIE JCT - SAFFORD US 191
Swift Trail Junction
Graham County

DATE: NOV 18, 2005 SHEET: 2 OF 2

November 18, 2005

RES. NO. 2005-11-A-059
PROJECT: N-810-601 / 191GH113H088801R
HIGHWAY: BOWIE JCT. - SAFFORD
SECTION: Swift Trail Junction
ROUTE NO.: U.S. Route 191
ENG. DIST.: Safford
COUNTY: Graham
PARCEL: 5-0464

REPORT AND RECOMMENDATION

TO THE HONORABLE ARIZONA TRANSPORTATION BOARD:

The Intermodal Transportation Division has made a thorough investigation concerning the establishment and improvement of a portion of U.S. Route 191 within the above referenced project.

This portion was previously established as a state route and state highway, designated State Route 81 by Arizona Highway Commission Resolution dated September 9, 1927, page 26 in the Official Minutes; Resolution dated April 13, 1934, page 567 in the Official Minutes, redesignated State Route 61 to U.S. Route 666; thereafter Arizona Transportation Board Resolution 92-09-A-064, dated September 18, 1992, designated and renumbered U.S. Route 666 to U.S. Route 191.

Additional right of way is needed for Parcel 5-0464, thought to have already been acquired for state transportation purposes. Accordingly, it is necessary to establish and acquire the additional right of way under this project.

The additional right of way to be established and acquired for this improvement is depicted in Appendix "A" and delineated on maps and plans on file in the office of the State Engineer, Intermodal Transportation Division, Phoenix, Arizona, entitled "Right of Way Plans, BOWIE JCT. - SAFFORD Highway, Project N-810-601 / 191GH113H088801R."

ARIZONA DEPARTMENT OF TRANSPORTATION
205 SOUTH 17TH AVENUE
R/W Operations, MD 612E
PHOENIX, AZ 85007-3213

November 18, 2005

RES. NO. 2005-11-A-059
PROJECT: N-810-601 / 191GH113H088801R
HIGHWAY: BOWIE JCT. - SAFFORD
SECTION: Swift Trail Junction
ROUTE NO.: U.S. Route 191
ENG. DIST.: Safford
COUNTY: Graham
PARCEL: 5-0464

RESOLUTION OF ESTABLISHMENT

VICTOR M. MENDEZ, Director, Arizona Department of Transportation, on November 18, 2005, presented and filed with this Transportation Board his written report under Arizona Revised Statutes Section 28-7046, recommending the establishment and acquisition of additional right of way for a portion of U.S. Route 191 as set forth in the above referenced project.

The additional right of way to be established and acquired is depicted in Appendix "A" and delineated on maps and plans on file in the office of the State Engineer, Intermodal Transportation Division, Phoenix, Arizona, entitled "Right of Way Plans, BOWIE JCT. - SAFFORD Highway, Project N-810-601 / 191GH113H088801R."

WHEREAS in a remedial effort to acquire additional right of way which was previously thought to have been acquired, establishment and acquisition of said additional right of way is now necessary; and

WHEREAS because of these premises, this Board finds public safety, necessity and convenience require the recommended establishment and acquisition of the additional land; therefore, be it

RESOLVED that the recommendation of the Director is adopted and made part of this resolution; be it further

November 18, 2005

RES. NO. 2005-11-A-059
PROJECT: N-810-601 / 191GH113H088801R
HIGHWAY: BOWIE JCT. - SAFFORD
SECTION: Swift Trail Junction
ROUTE NO.: U.S. Route 191
ENG. DIST.: Safford
COUNTY: Graham
PARCEL: 5-0464

RESOLVED that the portion of right of way as depicted in Appendix "A" is hereby designated a state route and state highway; be it further

RESOLVED that the Director is hereby authorized to acquire by lawful means, including exchanges, in accordance with Arizona Revised Statutes Section 28-7092, an estate in fee, or such other interest as is required; be it further

RESOLVED that the Director secure an appraisal of the property to be acquired and that necessary parties be compensated. Upon failure to acquire said lands by other lawful means, the Director is authorized to initiate condemnation proceedings.

November 18, 2005

RES. NO. 2005-11-A-059
PROJECT: N-210-601 / 191GN113H088F01R
HIGHWAY: BOWIE JCT. - SAFFORD
SECTION: Swift Trail Junction
ROUTE NO.: U.S. Route 191
ENG. DIST.: Safford
COUNTY: Graham
PARCEL: 5-0464

In the interest of public safety, necessity and convenience, I recommend that the area depicted in Appendix "A" be established and improved as a state route and state highway.

I further recommend the acquisition of the new right of way, material for construction, haul roads and various easements necessary for or incidental to the improvement.

Pursuant to Arizona Revised Statutes Section 29-7046, I recommend the adoption of a resolution making this recommendation effective.

Respectfully submitted,



VICTOR M. MENDEZ, Director
Arizona Department of Transportation

November 18, 2005

RES. NO. 2005-11-A-059
PROJECT: K-810-601 / 191GH113H088801R
HIGHWAY: BOWIE JCT. - SAFFORD
SECTION: Swift Trail Junction
ROUTE NO.: U.S. Route 191
ENG. DIST.: Safford
COUNTY: Graham
PARCEL: 5-0464

CERTIFICATION

I, VICTOR M. MENDEZ, Director of the Arizona Department of Transportation, do hereby certify that the foregoing is a true and correct copy from the minutes of the Transportation Board made in official session on November 18, 2005.

IN WITNESS WHEREOF I have hereunto set my hand and the official seal of the Transportation Board on November 18, 2005.

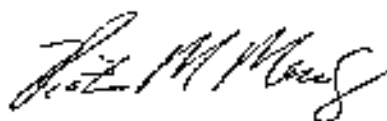

VICTOR M. MENDEZ, Director
Arizona Department of Transportation

